

DISASSEMBLY

1. 2WD:

REMOVE GREASE CAP

- (a) Mount the axle hub in a soft jaw vise.

HINT:

Close the vise until it holds the hub bolts. Do not tighten further.

- (b) Using a screwdriver, remove the grease cap.

2. 4WD:

REMOVE OIL SEAL (INSIDE)

- (a) Mount the axle hub in a soft jaw vise.

HINT:

Close the vise until it holds the hub bolts. Do not tighten further.

- (b) Using a screwdriver, remove the oil seal (inside).

3. 2WD:

REMOVE LOCK NUT AND ABS SPEED SENSOR ROTOR/SPACER

- (a) Using a chisel and hammer, loosen the staked part of the lock nut.

NOTICE:

Be careful not to damage the bushing.

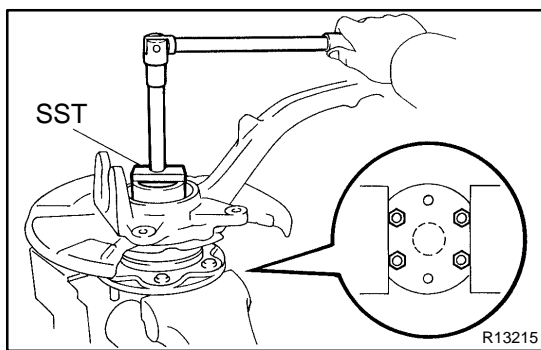

- (b) Using SST, remove the lock nut.

SST 09318-12010

- (c) Remove the ABS speed sensor rotor/spacer.

NOTICE:

Take care not to scratch the serration of the speed sensor rotor.

4. REMOVE AXLE HUB FROM STEERING KNUCKLE

- (a) Remove the 4 bolts and shift the dust cover towards the hub side (outside).

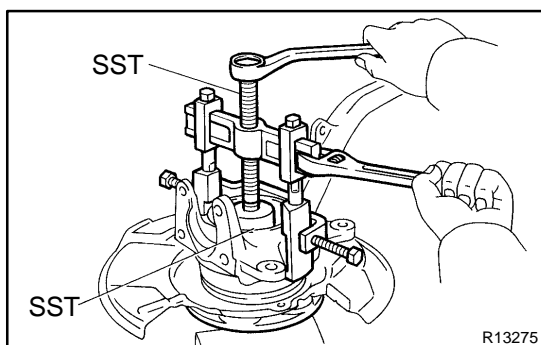

- (b) Using SST, remove the axle hub from the steering knuckle.

SST 09710-30021 (09710-03051),
09950-40011 (09951-04020, 09952-04010,
09953-04020, 09954-04010, 09955-04031,
09957-04010, 09958-04011)

- (c) Remove the dust cover from the steering knuckle.

- (d) 4WD:

Remove the bearing spacer and ABS speed sensor rotor (w/ ABS)/spacer (w/o ABS).

NOTICE:

Take care not to scratch the serration of the speed sensor rotor.

5. REMOVE OIL SEAL (OUTSIDE)

Using a screwdriver, remove the oil seal (outside) from the steering knuckle.

6. REMOVE BEARING FROM STEERING KNUCKLE

(a) Using snap ring pliers, remove the snap ring.

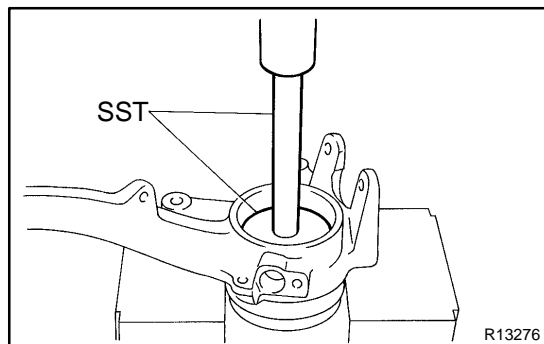

(b) Using SST and a press, remove the bearing from the steering knuckle.

SST 09950-60020 (09951-00810),
09950-70010 (09951-07150)